

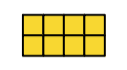

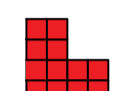



KEY

-  Buff tactile paving for uncontrolled crossings.
-  Red tactile paving for controlled crossings.
-  New footway surfacing
-  Grass verge, with wild flowers
-  Concrete double bus lay-by
-  Shared un-segregated footway markings
-  New bus shelter supplied and installed by Clear Channel

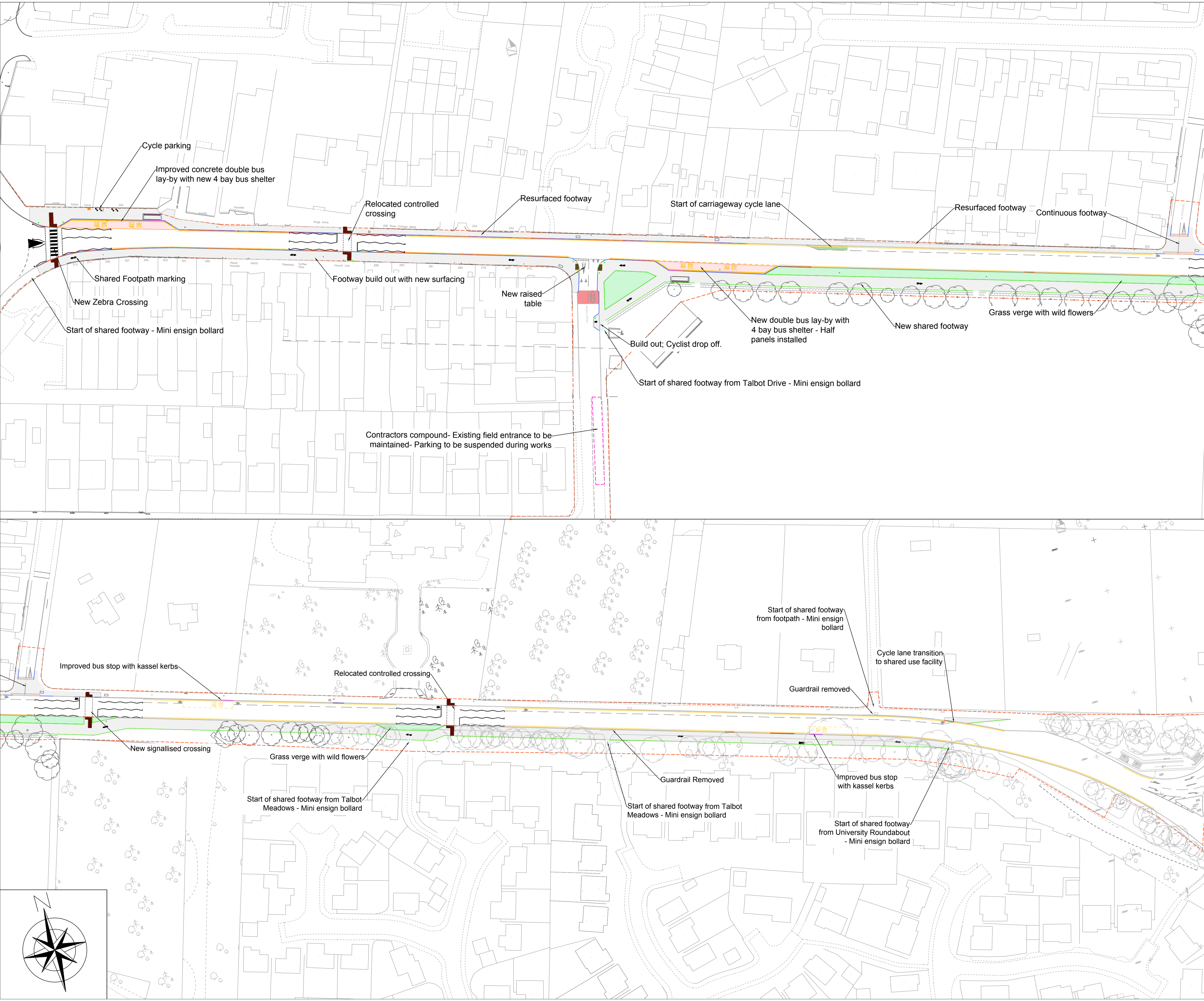

This map is reproduced from Ordnance Survey material with the permission of Ordnance Survey on behalf of the Controller of Her Majesty's Stationary Office © Crown Copyright. Unauthorised reproduction infringes Crown copyright and may lead to prosecution or civil proceedings. Bournemouth Borough Council Licence No. 100019829.2019

P1	26.06.19	Public GA	SP
Issue	Date	Amendments	Checked



**Wallisdown Improvements  
Phase 1  
General Arrangement**

Drawn: AS	Drawing Number: Z5157-100-01	Rev: A
Scale: NTS		

